

ROOF CURB FIELD ASSEMBLY INSTRUCTIONS

- STEP 1:** THE (-1) END/MIDDLE PIECES HAVE (2) ALIGNMENT HOLES PER SIDE THAT ARE TO BE USED AS GUIDES WHEN ZIP-SCREWING THE (-2) SIDE PIECES TO THEM.
- STEP 2:** ONCE THE PILOT SCREWS ARE IN PLACE, ADD (3) MORE ZIP-SCREWS FOR A TOTAL OF (5) SCREWS FOR EACH JOINT.
- STEP 3:** AFTER ALL ZIP-SCREWS HAVE BEEN PLACED, USE DIMENSION "C" TO SQUARE THE CURB.

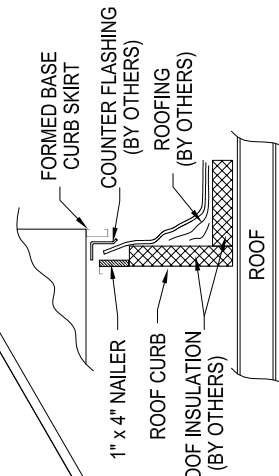
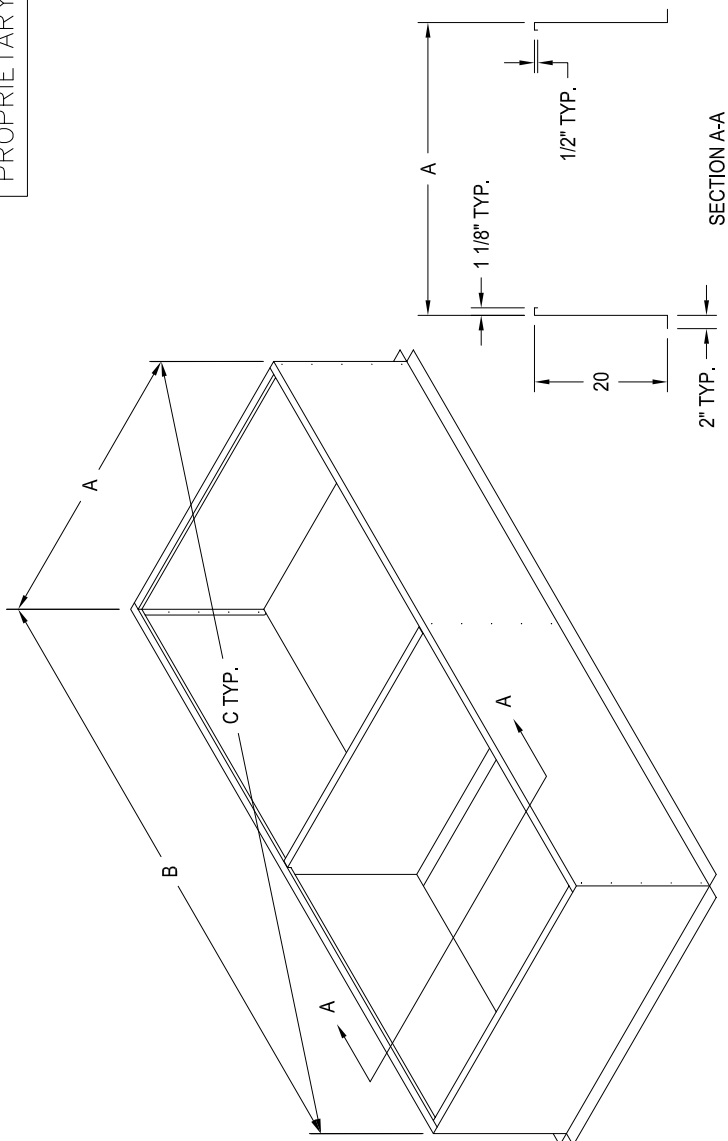
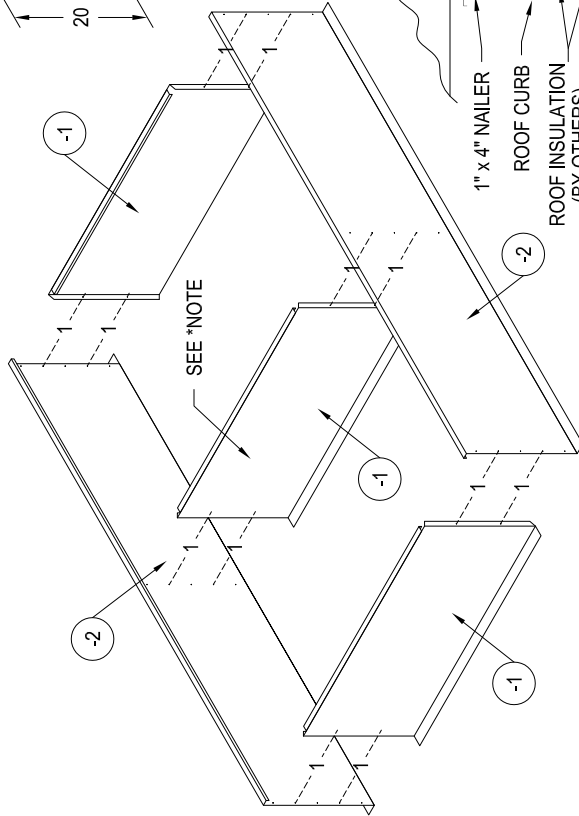

**** NOTE: MIDDLE PIECE NOT INCLUDED ON V1-V2 CURBS WITH "B" DIMENSION OF 45", 67" OR 75"**

MODEL	UNIT ONLY		WEIGHT/ALUM. GALV.	UNIT w/SAFS		WEIGHT/ALUM. GALV.
	A	B		C	C	
V1	23"	45"	20#	75"	78-7/16"	30#
V2	27"	67"	25#	97"	100-11/16"	35#
V3	35"	87"	35#	117"	122-1/8"	45#
V4	43"	91"	40#	121"	128-7/16"	50#
V5	50"	91"	45#	121"	130-15/16"	55#

LAST REVISION:	UPDATE NOTE FOR MIDDLE PIECE	CK BY:	AMB	DATE:	09-21-10
NOTES:		NET QTY:		MATERIAL:	
		MATERIAL SIZE:			
<p>AbsolutAire, Inc. 5496 North Riverview Dr., Kalamazoo MI 49004</p>					
DESC. V1-V5 - FLAT FULL CURB ASSEMBLY (SHIPPED K.D.)					
SCALE:	NONE	DRAWN BY:	ADR	DATE:	08-16-05
PLOT RATIO:	1=28	CK BY:		WO#:	
DRAWING FILE LOCATION:	T:\WSVCURB	REV.:	B	DATE:	07-02-15
		REV.:	C	DATE:	11-19-15
		REV.:	D	DATE:	05-07-18
		REV.:	E	DATE:	05-28-19
		REV.:	F	DATE:	
		FILE NO.:		REV.:	F
		VFC:			

PROPRIETARY