

STEP A:

(3) NUT INSERTS TYP.

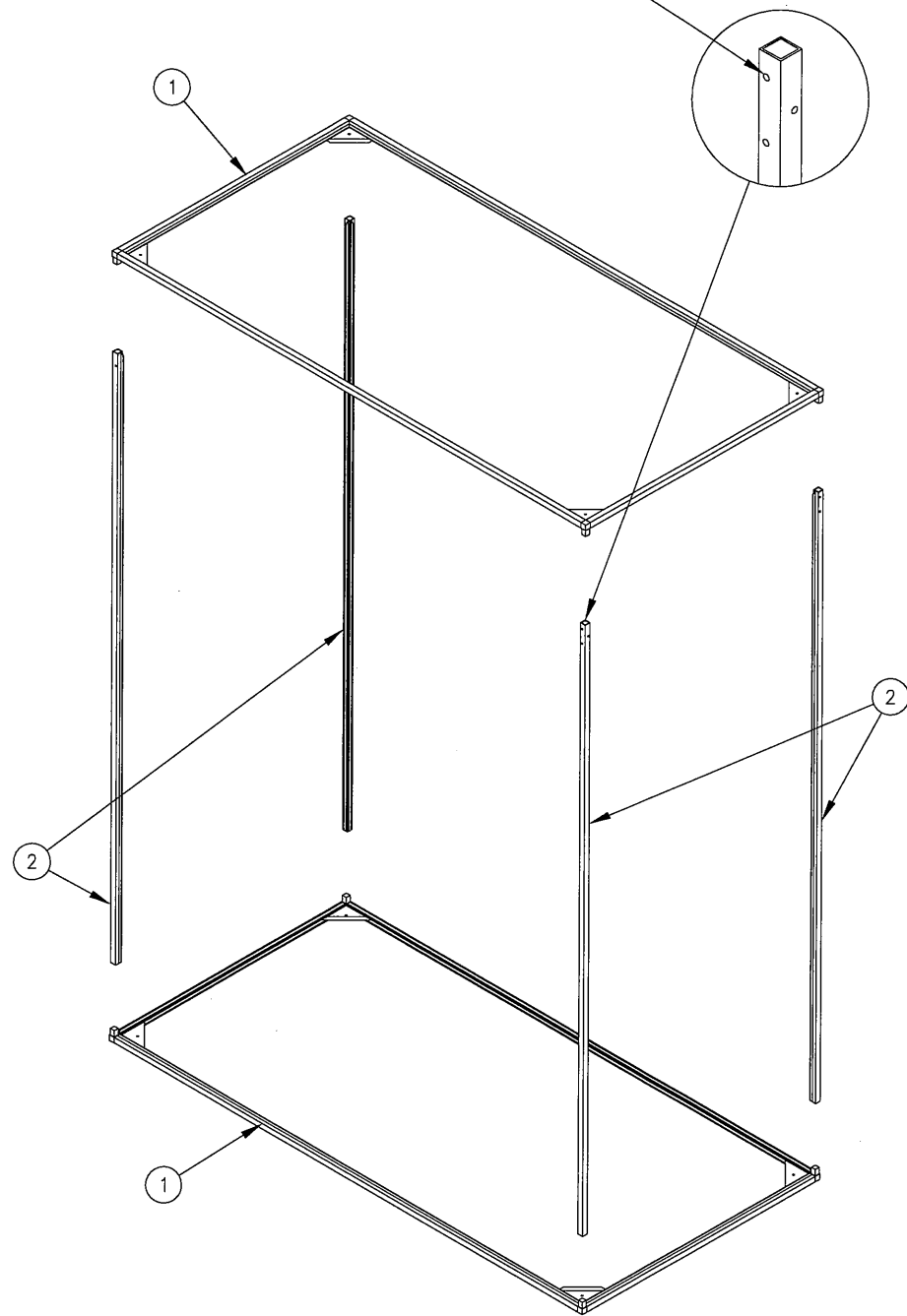

Assemble 1-1/2" tube frame using items 1 & 2. Item 2 has (3) 1/4-20 nut inserts in one end only. Orient item 2 the same direction for all (4) pieces. See detail above.

The nut inserts are used for bolting the lifting lugs (item 3) to the tube frame (step C).

STEP B:

Fasten wall panels to 1-1/2" tube frame using 1-3/4" long zip screws. (6) clearance holes per panel are pre drilled and ready for screws.

Note: The (4) top panels and (4) bottom panels will need to be fastened to the top frame and bottom frame in the same fashion, but do not have clearance holes pre drilled on the top/bottom of panel. See below.

Note: The number of panels per extension section will vary depending on the overall height of the extension.

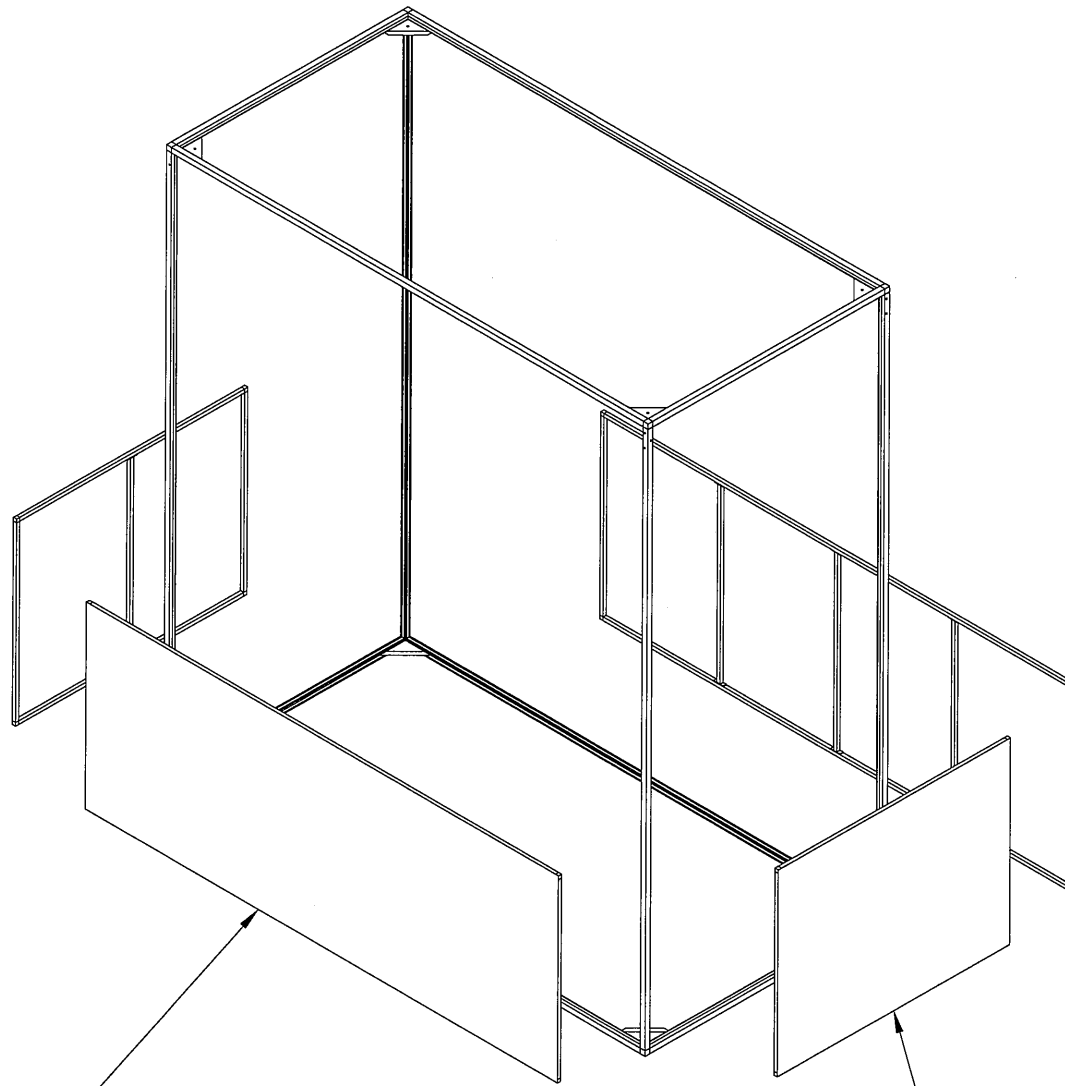

Drill holes thru bottom wall panels:

(5) evenly spaced holes on long side panels.

(3) evenly spaced holes on short side panels.

Fasten panels to the bottom extrusion flange. Repeat this process for the top wall panels so they attach to the top extrusion flange.

STEP C:

PROPRIETARY

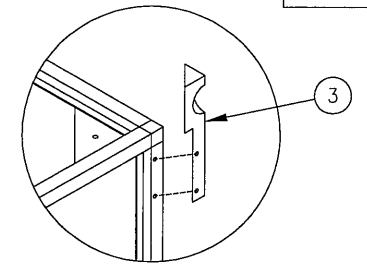

Attach lifting lugs (item 3) using (3) 1/4-20 bolts. (4) lifting lugs total, (1) per corner.

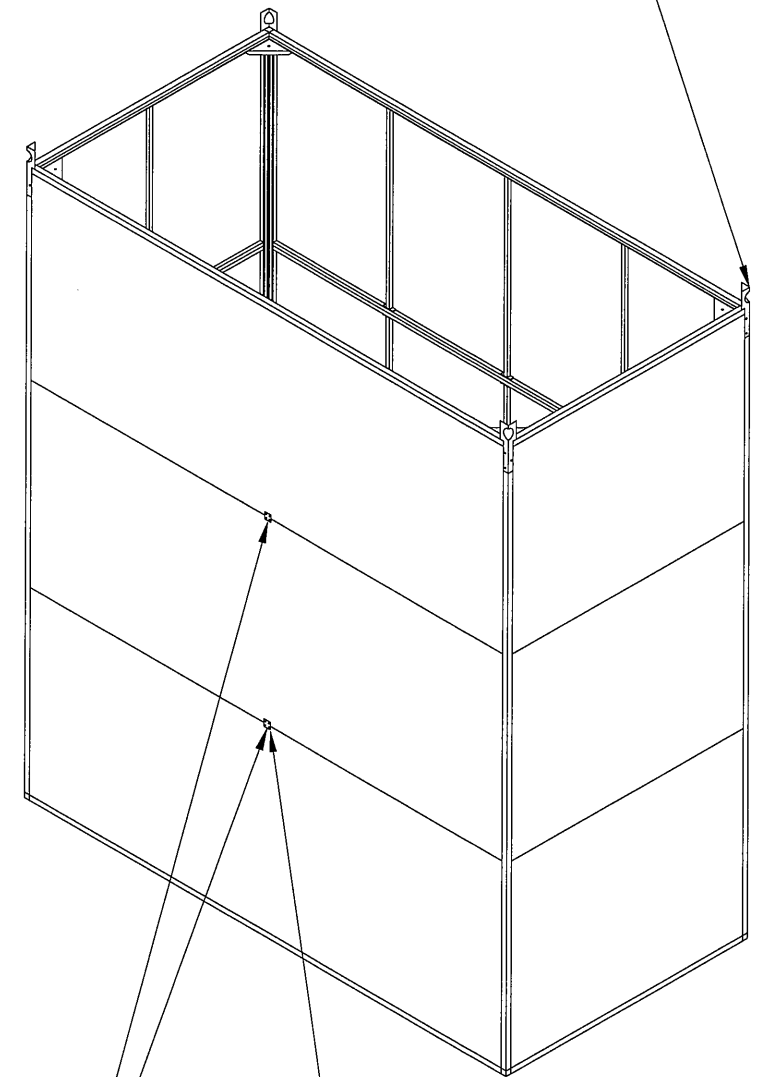

Fasten the longer wall panels to each other using item 4. See diagram above.

LAST REVISION:	-	REV.	ECO#	DATE	CK BY	Absolut Aire, Inc. 5496 North Riverview Dr., Kalamazoo MI 49004							
NOTES:										DESC.	DUCT EXTENSION INSTALLATION - DOUBLE FAN UNITS		
DRAWING FILE LOCATION:	U:\E-SERIES	AAI PART #:	-			SCALE	NONE	DRAWN BY:	CAP	DATE:	8-27-09	REV.	FILE NO.:
						PLOT RATIO:	1=48	CK BY:	-	WO#	-	-	Ext Installation